

This Flange is Movable, with the Help of a Stubend. The Stubend is Welded to the Flexible Hose, while the Flange is Movable. This is called Swivel Type Flanged End Connection

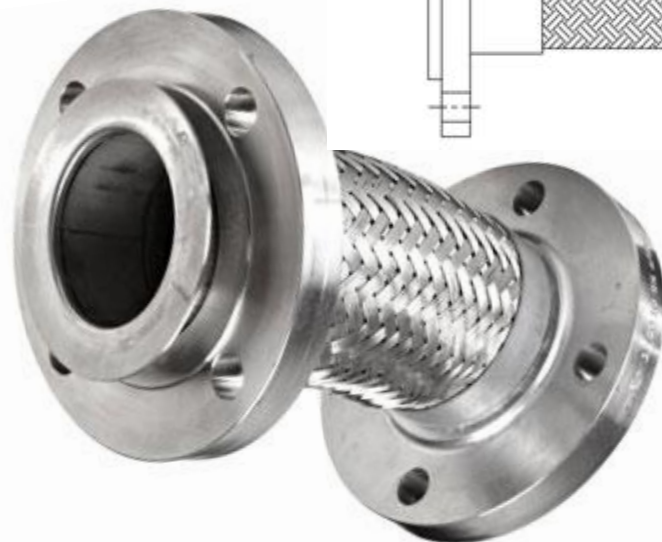
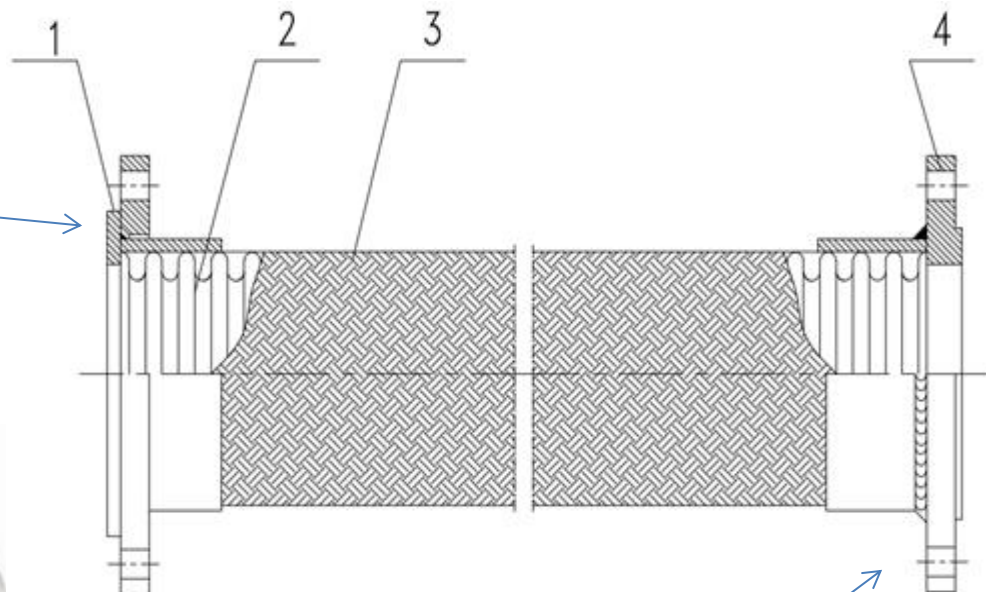

This Flange is Fixed and Welded to the Flexible Hose. This is Fixed Type Flanged End Connection.

Types of Flanged End Flexible Hoses : **Both Side Fixed**, **Both Side Swivel Type** or **One Side Fixed & One Side Swivel**

NO.S	ITEMS	MATERIALS (Stainless steel)	REMARK
1	Floating Flange, with Stub End	SS 304	Flange - ANSI B16.5, 150 Class Stubend (MSSP 43)
2	Inner Bellow	SS 304	Annular Corrugation, with Close Pitch
3	Outer Braids	SS 304	1 Layer
4	Fixed flange	SS 304	ANSI B16.5, 150 Class